

**From:** Kok Tiong TAN (SLA)  
**Sent:** Wednesday, 16 March, 2011 11:59 AM  
**To:**

**Subject:** CS CIRCULAR NO. 3/2011 - TO INDICATE WHOLE OR PART OF PHYSICAL PARENT LOTS ON ANNEX B-2

Our Ref: SLA/SVY 251-72 Vol 6

To All Registered Surveyors

Dear Sirs / Madams

**TO INDICATE WHOLE OR PART OF PHYSICAL PARENT LOTS ON ANNEX B-2**

I attach CS Circular No. 3/2011 which is self-explanatory for your information.

Yours faithfully

**TAN KOK TIONG • Consultant • Land Survey Division • Regulatory Cluster**  
**Singapore Land Authority • 6478-3947 (DID) • 6323-9937 (Fax) • <http://www.sla.gov.sg>**



[CONFIDENTIALITY: If you receive this email in error, you should delete it and not disseminate it or its contents in any form. Please also inform the sender that this email is in error. This email may contain confidential information and the [Official Secrets Act \(Cap 213\)](#) would make the unauthorised disclosure of this information a criminal offence.]



Our Ref : SLA/SVY 251/72 Vol 6

Date: 16 Mar 2011

**CS CIRCULAR NO. 3/2011**

To: All Registered Surveyors



**SINGAPORE  
LAND AUTHORITY**

55 Newton Road  
#12-01 Revenue House  
Singapore 307987  
Main: (65) 6323 9829  
Fax: (65) 6323 9937  
Website: [www.sla.gov.sg](http://www.sla.gov.sg)

**TO INDICATE WHOLE OR PART OF PHYSICAL PARENT LOTS ON ANNEX B-2**

Please refer to CS Circular No. 1/2011 on the subject "Submission of Child Lots – Physical Parent Lots Information".

2 Henceforth, the Child Lots-Physical Parent Lots information would have to indicate whether the child lot is derived from the whole or part of the Physical Parent Lots. Please refer to attached Annex A and the new Annex B-2 (sample letter for your use). This requirement is arising from a customer's feedback.

3 Please also note that the Child Lots-Physical Parent Lots information may have to be submitted for big or multiple developments being constructed in phases or varying stages. Normally you would apply for the new lot numbers phase by phase or in stages. Where such developments involve amalgamation of physical parent lots as "dummy" lot upfront in any preceding phase/stage and no CP for the preceding phase/stage has been approved yet, you have to provide the Child Lots-Physical Parent Lots information at each subsequent phase/stage.

4 Please ensure all details of the Child Lots-Physical Parent Lots information are entered in Annex B-2 before submitting it to us and sending a copy to your clients for them to forward it to their Solicitors.

A handwritten signature in black ink, appearing to read 'Tan Kok Tiong', written in a cursive style.

**TAN KOK TIONG**  
for CHIEF SURVEYOR

DID: (65) 64783947

Email: [tan\\_kok\\_tiong@sla.gov.sg](mailto:tan_kok_tiong@sla.gov.sg)

## SKETCH PPL

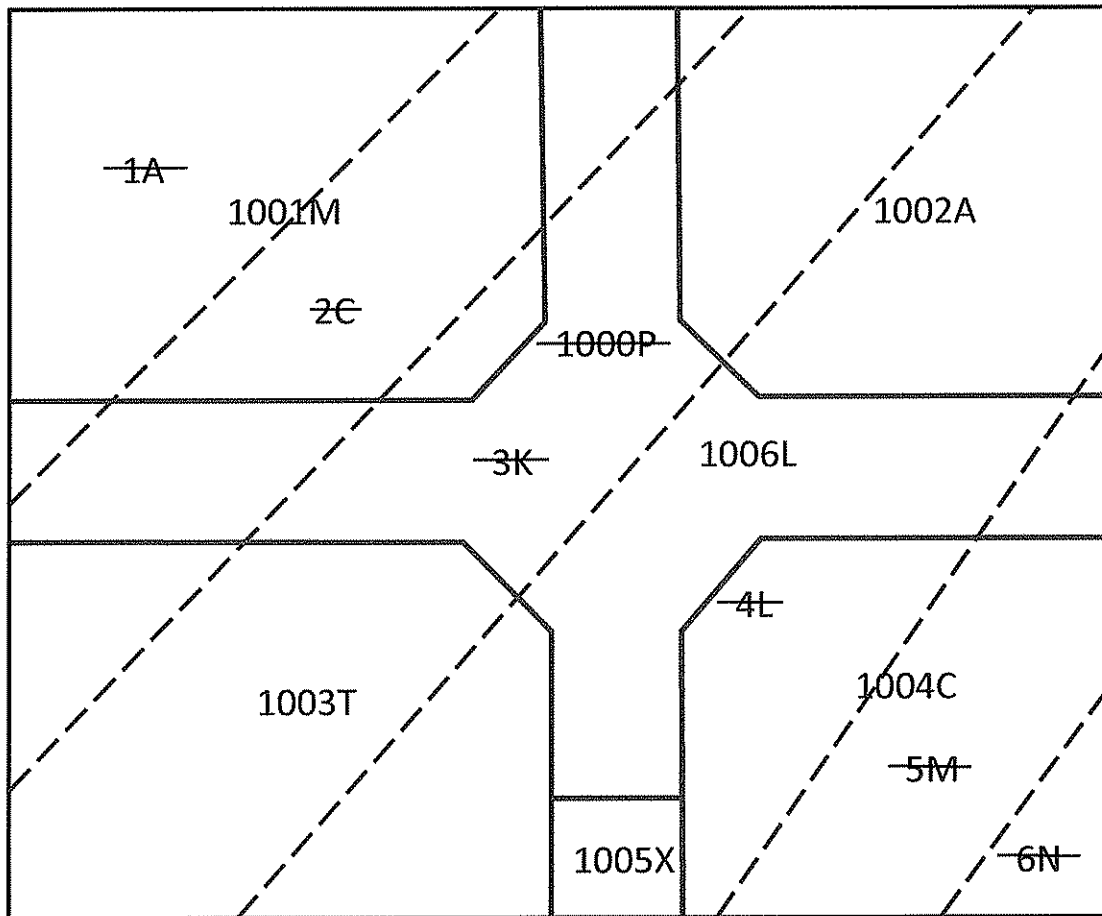

## Note:

- (a) Physical Parent Lots 1A to 6N are amalgamated as "Dummy" Lot 1000P.
- (b) Lot 1000P is subdivided into Child Lots 1001M to 1006L.

(SAMPLE OF LETTER FORMAT)

Our Ref: \_\_\_\_\_

Your Ref: SLA/SVY\_\_\_\_\_

Date: \_\_\_\_\_

To: Chief Surveyor  
Singapore Land Authority**CHILD LOTS 1001M TO 1006L & PHYSICAL PARENT LOTS 1A TO 6N MK \_\_ AT 22 XYZ ROAD**

The "Child lots-Physical Parent Lots" relationship is as listed below. The relationship is subject to approval of the final survey.

Yours faithfully,

\_\_\_\_\_  
(Name)  
Registered Surveyor

cc

Clients (Developers / Landowners)

Please forward this letter to your Solicitors.

MK/TS No:		
No	Child Lot	Physical Parent Lot
1	1001M	Part of Lots 1A, 2C, 3K
2	1002A	Part of Lots 2C, 3K 4L, 5M
3	1003T	Part of Lots 2C, 3K, 4L
4	1004C	Part of Lots 4L, 5M and whole of Lot 6N
5	1005X	Part of Lot 4L
6	1006L	Part of Lots 1A, 2C, 3K, 4L, 5M